

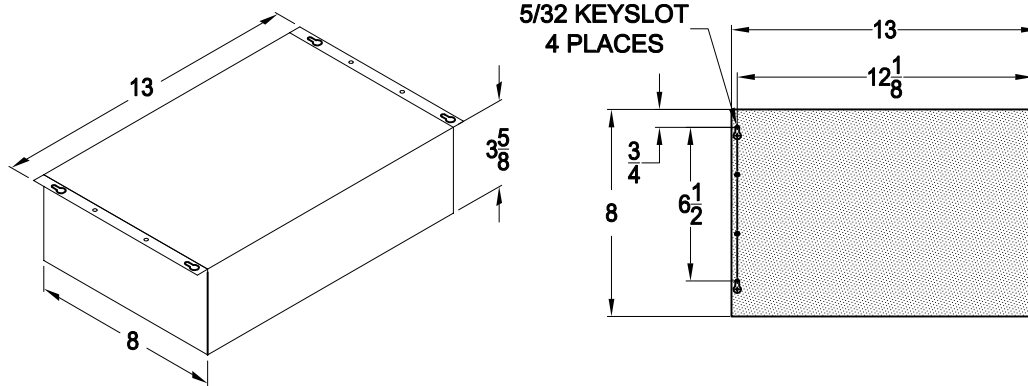

# SKCAB-XXXXXX

Ver. 9 Rel. 10/11/2012

## CEILING MOUNT (HORIZONTAL)



## CAB TOP MOUNT (VERTICAL)

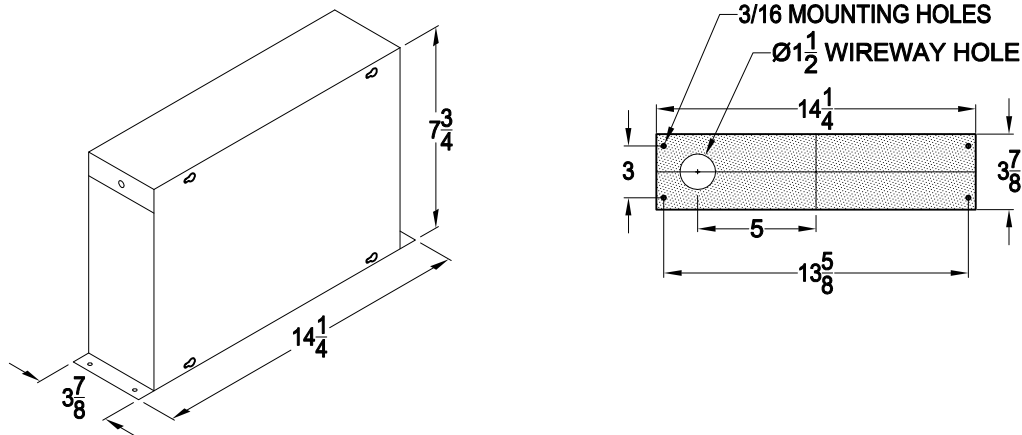

## ELEVATOR CAB LIGHTING

The SK-CAB battery backed cab lighting system was designed to provide an intelligent efficient LED based lighting solution for elevator cabs. In the event of a power outage, it also incorporates an emergency battery back up system to provide power for lights and a cab-operated alarm.

### Features:

- Dimming input with on/off and 8 brightness settings.
- External light switch input.
- 30-month battery life indication.
- 3W and 9W models available.
- When activated in Emergency Power condition 2 of the Led Lamps are turned on using CE's Intelli-Socket design. This Intelli-Socket design monitors all circuits for Loads and keeps two of the Led's on while activated meeting ASME A17 code.
- Incorporates intelligent load software.
- Options for: 6V, 12V, and 24V alarm drivers.
- Optional: Sonalert Alarm added
- Top of cab or ceiling-mount / clam shell options available.



- Optional: SKDIM remote dimmer feature available

### Battery backup mode provides emergency power for:

- 2 lamps powered for 4 hours. Unit will automatically power two lamps. If the designated lamp socket is empty or a lamp burns out, a new lamp will be turned on.
- 1 bell powered for 1 hour. 80-90 DBA @ 3 meters

**TO ORDER:-SPECIFY SKCAB - X X X X X X**

WATTS:  
 "03" = 3 WATTS - 6, 9 or 12 LAMP  
 "09" = 9 WATTS - 6 or 9 LAMP MAX  
 "ME" = MR16/E27

NUMBER OF LAMP OUTPUTS

"06" = 6 LAMPS  
 "09" = 9 LAMPS  
 "12" = 12 LAMPS - 3WATT ONLY

"X" = BATTERY W/ MULTI VOLT BELL OUTPUT  
 NO BELL INCLUDED  
 "D" = SONALERT ADDED  
 "Z" = NO BATTERY

BOX:  
 "H" = HORIZONTAL / CLAM SHELL  
 "V" = VERTICAL / TOC