

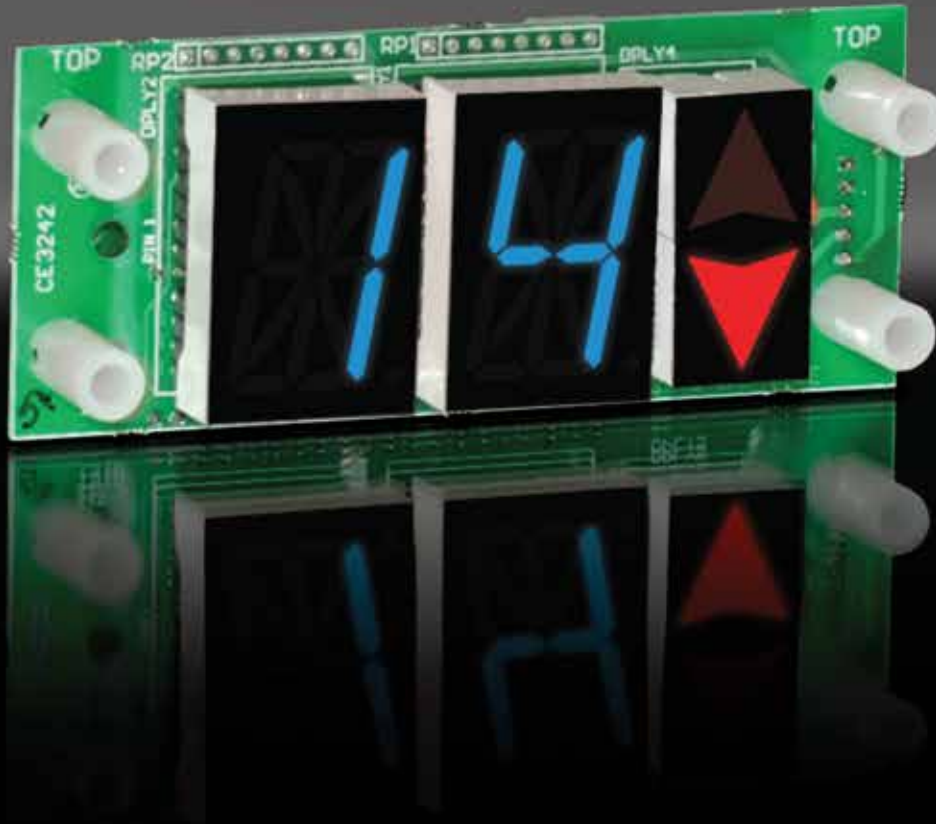

MH310-XXX

REMOTE DISPLAY INDICATOR "RDI"



MICRO COMM

1" CHARACTERS

Segmented LED, digital indicator for floor position display, as well as car direction. Any alphanumeric character can be displayed in either single or double digit floor designations.

TYPICAL APPLICATIONS:

- > Car-OP Panel
- > Transom-car or Hall

FEATURES:

- > Fast, 3-wire hookup
- > Latched inputs
- > Cross wire protected
- > Self testing
- > Alternate message
- > Passing chime output
- > Low profile
- > Error detection and correction feature



C.E. Electronics, Inc. (US) 2107 Industrial Drive, Bryan, Ohio 43506 p: 419.636.6705 www.ceelectronics.com

C.E. Electronics, Ltd. (UK) P.O. Box 1679 Marlow, Bucks SL7 3ZG, UK p: +44 (0) 1628 487633 www.ceelectronics.co.uk



C.E. Electronics, Inc.
 2107 Industrial Drive
 Bryan, OH 43506
 PH (419) 636-6705 FX (419) 636-2516
 www.ceelectronics.com

MH310-XXX

Ver. 7 Rel. 11/03/2016

MICRO COMM[®]
 DISPLAYS

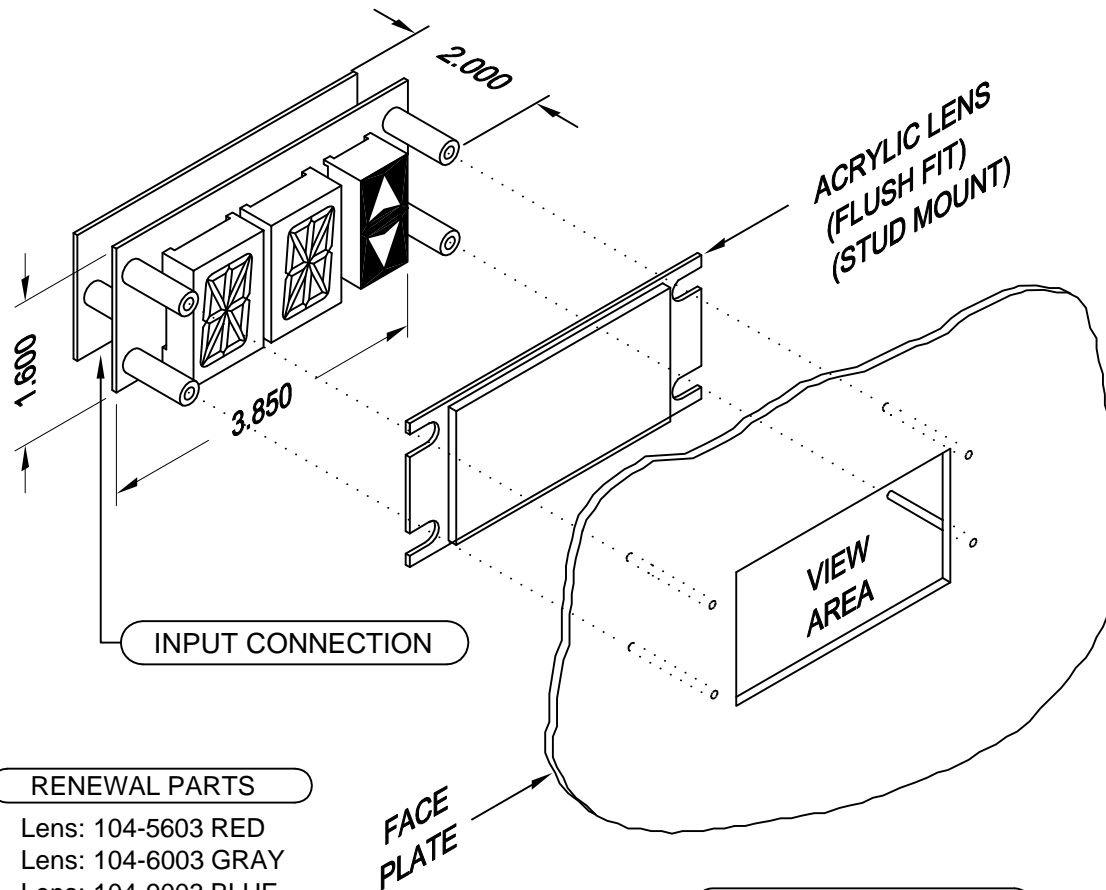

- RENEWAL PARTS**
- Lens: 104-5603 RED
 - Lens: 104-6003 GRAY
 - Lens: 104-9003 BLUE

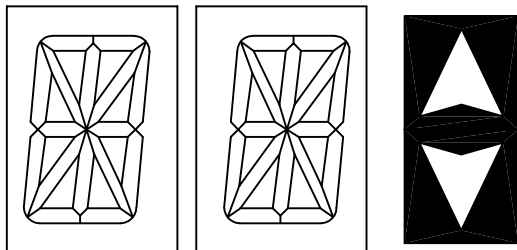

1 INCH CHARACTER

NOTE:

1. This is not a stand alone unit. Must be used in conjunction with a Micro Comm interface.

PANEL PREPARATION

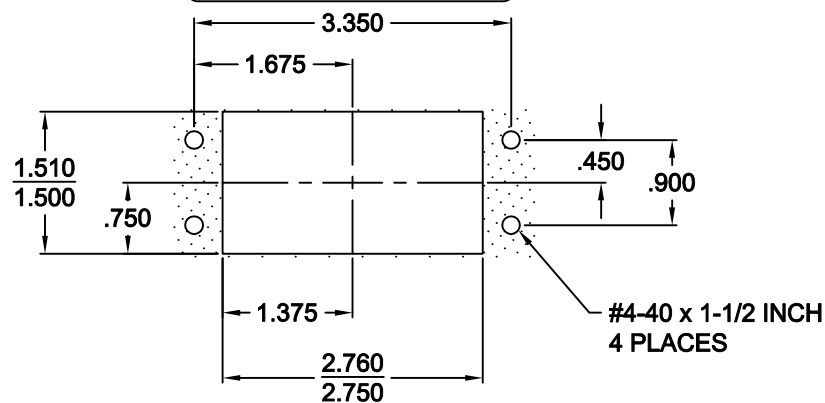

REMOTE DISPLAY INDICATOR "RDI"

Segmented LED, digital indicator for floor position display, as well as car direction. Any alphanumeric character can be displayed in either single or double digit floor designations.

Typical Applications

- Car-OP Panel
- Transom-car or Hall

Features

- Fast, 3-wire hookup
- Latched inputs
- Cross wire protected
- Self testing
- Alternate message
- Passing chime output
- Low profile
- Error detection and correction feature

TO ORDER - SPECIFY MH310 - X X X

COLOR:

- "RR" = RED w/RED ARROWS
- "AR" = AMBER w/RED ARROWS
- "GR" = GREEN w/RED ARROWS
- "BR" = BLUE w/RED ARROWS
- "WR" = WHITE w/RED ARROWS
- "GG" = GREEN w/GREEN ARROWS
- "BB" = BLUE w/BLUE ARROWS
- "WW" = WHITE w/WHITE ARROWS

LENS:

- "R" = RED
- "G" = GRAY
- "B" = BLUE
- "X" = NO LENS